

### Impact Safety-Rated and Fire-Rated Wired Glass Solution

SuperLite I-W is the first patented wired glass product to meet the highest federal impact safety standard, Consumer Product Safety Commission Cat. II, which requires withstanding 400 ft. lbs. of impact, and is perfect for use in door and sidelite applications where impact safety is required or a concern. Standard wired glass lost its exemption from safety requirements due to the many injuries caused by its use in K-12 schools. SuperLite I-W was developed by SAFTI FIRST™ to provide an inexpensive replacement for non-safety traditional wired glass.

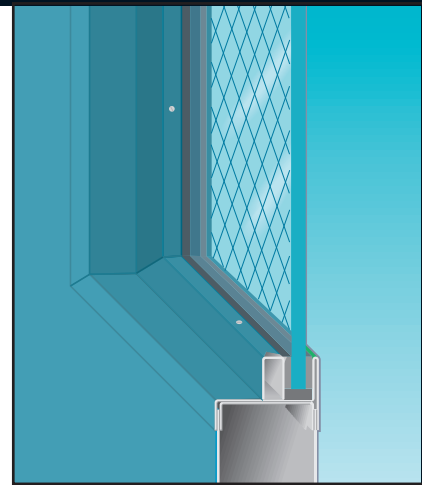

SuperLite I-W in SAFTI Fire HM  
Hollow Metal framing



FIRE RATED



HOSE STREAM



IMPACT RATED



THERMAL SHOCK



POSITIVE PRESSURE

### SuperLite I-W Product Features

- Traditional fire-rated glass with a tough, durable fire-rated safety film applied to meet highest impact safety standard, CPSC 16CFR 1201 Cat. II, which requires withstanding 400 ft. lbs. of impact.
- Ideal replacement for traditional unsafe wired glass
- Positive pressure fire rated.
- 1/4" (7mm) for use in standard hollow metal.
- Fabricated in the USA for fast delivery.
- For use in steel, wood, aluminum or any equally rated fire-rated framing system.

Fire Rating*	Application	Max. Lite Area**	Max. "W"	Max. "H"	Stops	Testing
20 minutes	Doors	2,856 sq. in.	36"	84"	5/8"	
20 minutes	Sidelites	4,704 sq. in.	106"	106"	5/8"	
20 minutes	Windows / Transoms	4,704 sq. in.	106"	106"	5/8"	
45 minutes	Doors	2,856 sq. in.	36"	84"	5/8"	
45 minutes	Sidelites	4,704 sq. in.	106"	106"	5/8"	
45 minutes	Windows / Transoms	4,704 sq. in.	106"	106"	5/8"	
60 minutes	Doors (temp. rise)	100 sq. in.	12"	33"	5/8"	
60 minutes	Doors (non-temp. rise)	2,856 sq. in.	36"	84"	5/8"	
90 minutes	Doors (temp. rise)	100 sq. in.	12"	33"	5/8"	
90 minutes	Doors (non-temp. rise)	2,208 sq. in.	36"	84"	5/8"	

\* For ratings over 45 minutes, the dangers of radiant heat should be considered. This is not a heat barrier ASTM E119 rated product.

\*\* Due to radiant heat considerations, the maximum wall area allowed by code is 25%.

## Product Specifications

Thickness: 1/4" (7mm)

Weight: 3.8 lbs./sq. ft.

Appearance: Wired



## Listed and Labeled

SuperLite I-W is listed and labeled with hose stream and positive pressure by Intertek/Warnock Hersey, Inc. Intertek/Warnock Hersey permanent labels are applied to all glass lites.



## Standards

UBC 7-2, UBC 7-4, NFPA 252, NFPA 257, UL 9, UL 10B, UL 10C, ASTM E2074, ASTM E152, ASTM E2010, ASTM E163, ULC CAN4-S104-M80, ULC CAN4-S106-M80.

## Delivery

Allow 5 days from confirmed order. Quick ship is available upon request.

## Typical Framing for SuperLite I-W™

Visit [www.safti.com](http://www.safti.com) for downloadable 3-part specifications, full CAD details, and a complete selection of SAFTI*fire*™ Framing.

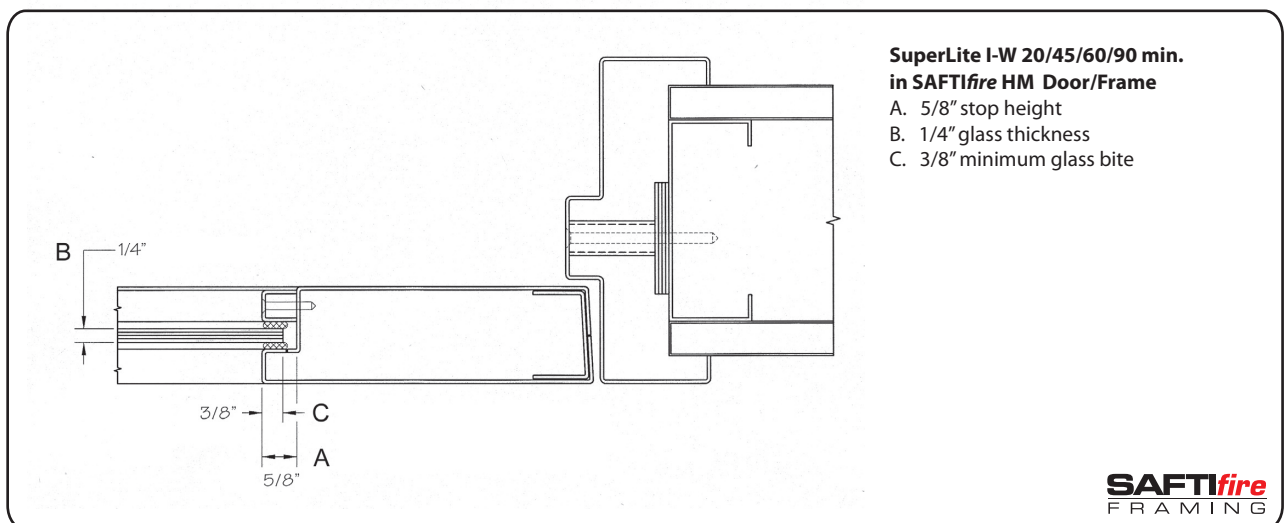
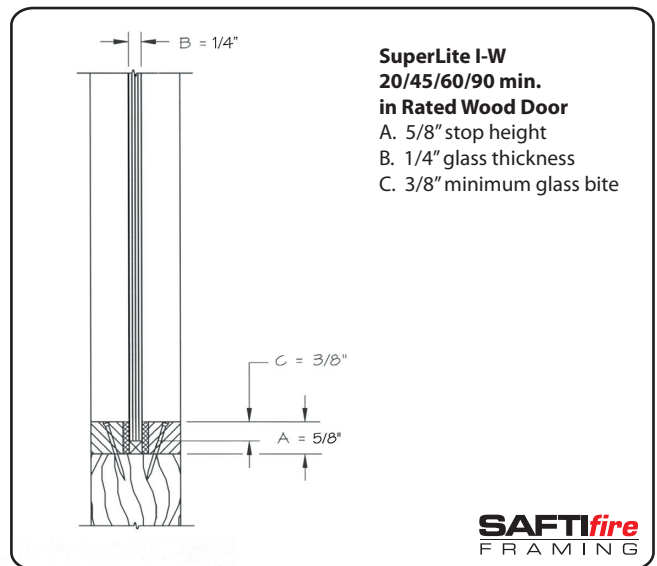
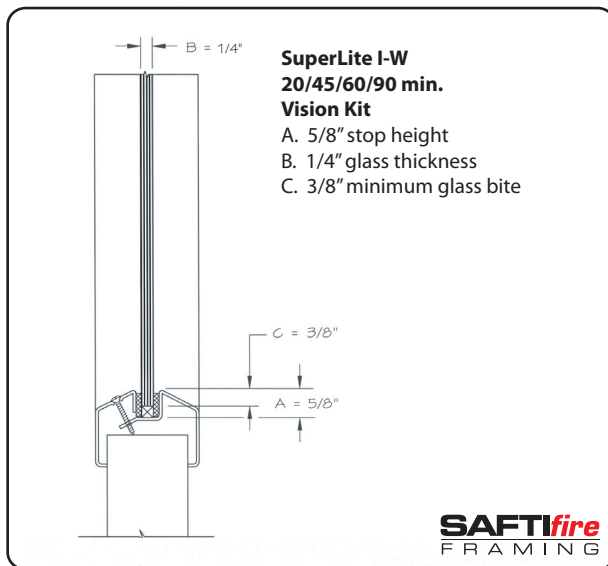

The information provided herein is for general reference only. SAFTI *FIRST* has endeavored to provide current information and cannot warrant or be responsible for errors and omissions.